

施工说明书 Installation Manual

安装产品前请仔细阅读本施工说明书，并保留备用。
Before installing the product, please read the Installation Manual carefully and keep it for future reference.

TOTO



请扫码获取说明书

※二维码无法获取到说明书时，以下网址可以下载说明书。
https://www.toto.com.cn/cn/instruction/instruction_search.html

安装完成后，本说明书务必交由客户保存。
After installation, the manual must be kept by the customer.

TOTO



0G518G
2025.04

目录

目 录	
目 录	1
明细单	2-3
使用条件与施工上的注意	4
施工上的注意与保养	5
安装完成图	6-7
水嘴的安装	8-10
生产厂家与销售商	11

明细单

明细单	
水嘴主体部	1套
手柄部	1套
切替捏手部	1套
装饰板	1个
衬板	1个
螺钉	4个
六角扳手	1个
施工说明书	1本
使用说明书	1本

明细单

使用此明细单的产品包括：

- TBG13303* 铜合金壁式单柄双控暗装水嘴面板
- TBG13304* 铜合金壁式单柄双控暗装水嘴面板（可转换）



注：TBG13303*、TBG13304*场合下无切替握手。

使用条件与施工上的注意

使用条件

- 1. 供冷水*热水压力：
 - 最低压强……………0.05MPa（流动压）
 - 最高压强……………1.0MPa（静压）
 - 推荐使用压强……………0.1-0.5MPa（流动压）
 - 检测压强……………1.6MPa（静压）
- 2. 供水温度在4℃～90℃，建议使用热水温度60℃，供热水请勿使用蒸汽。
- 3. 使用环境温度0℃以上。如果低于0℃，水嘴会出现变形、冻裂等现象。
- 4. 长时间不使用时，可能导致水嘴内部及外部锈蚀不能使用等现象。
- 5. 如果您需要废弃本产品，请勿将其作为一般生活垃圾处理，请依照法规经由独立的回收体系进行合适的处理、恢复和回收。
- 6. 本说明书中的产品具有清洗功能。

施工上的注意

-  **警告** 表示如果无视此标志而误操作时，有造成人员重伤或死亡。
-  **注意** 表示如果无视此标志而误操作时，有造成人身伤害或财产损失。

警告

- 1. 水嘴的供热水一侧处于高温状态，请勿使皮肤直接接触五金配件表面，否则可能会烫伤。
- 2. 请勿配反冷*热水配管，否则可能会烫伤。
- 3. 供热水请勿使用蒸汽，否则可能会烫伤。
- 4. 当直接从吐水口侧切换到淋浴器侧或从淋浴器侧切换到吐水口侧时，水温会发生变化，要用手测试水温后再使用，否则可能会烫伤。

施工上的注意与保养

⚠ 注意

1. 由于陶瓷阀芯是较精密的部件，请勿擅自分解，否则可能会造成漏水等不良。
2. 请勿撞击本产品，否则可能会造成故障、漏水。
3. 随着产品式样的不断更新，实物存在与图示不符的情况，但基本安装、使用原理相同。
4. 由于出厂前进行通水检查，故水嘴内可能有残留水，并非产品有问题。
5. 在可能结冰的场所使用时，要切实做好防冻措施。
因结冰，零件破损，有可能导致漏水，造成财产损失。因结冰而造成的破损即使在保修期内也是有偿修理。请不要让产品的环境温度低于0℃。

防冻措施

- 在可能结冰的场所使用时，要切实做好防冻措施。
1. 产品结冰的话零件损坏，成为漏水的原因。
 2. 因结冰造成的零件破损即使在保修期也是有偿修理。
 3. 施工完了后或长时间不使用时，要有预防突然降温的准备，要对产品进行结冰预防。
 4. 因为有结冰的危险，请不要让产品周围的温度在0℃以下。

保养

- 为长期保持产品的美观，请用户按以下方法维护保养。
1. 经常用软布擦拭，间或用软布蘸水擦拭。
 2. 当有污垢且比较明显时，请用中性洗涤剂擦拭后充分进行水洗。

安装完成图

TBG13303*铜合金壁式单柄双控暗装水嘴面板
与「TOTO」的其他产品配合示意图

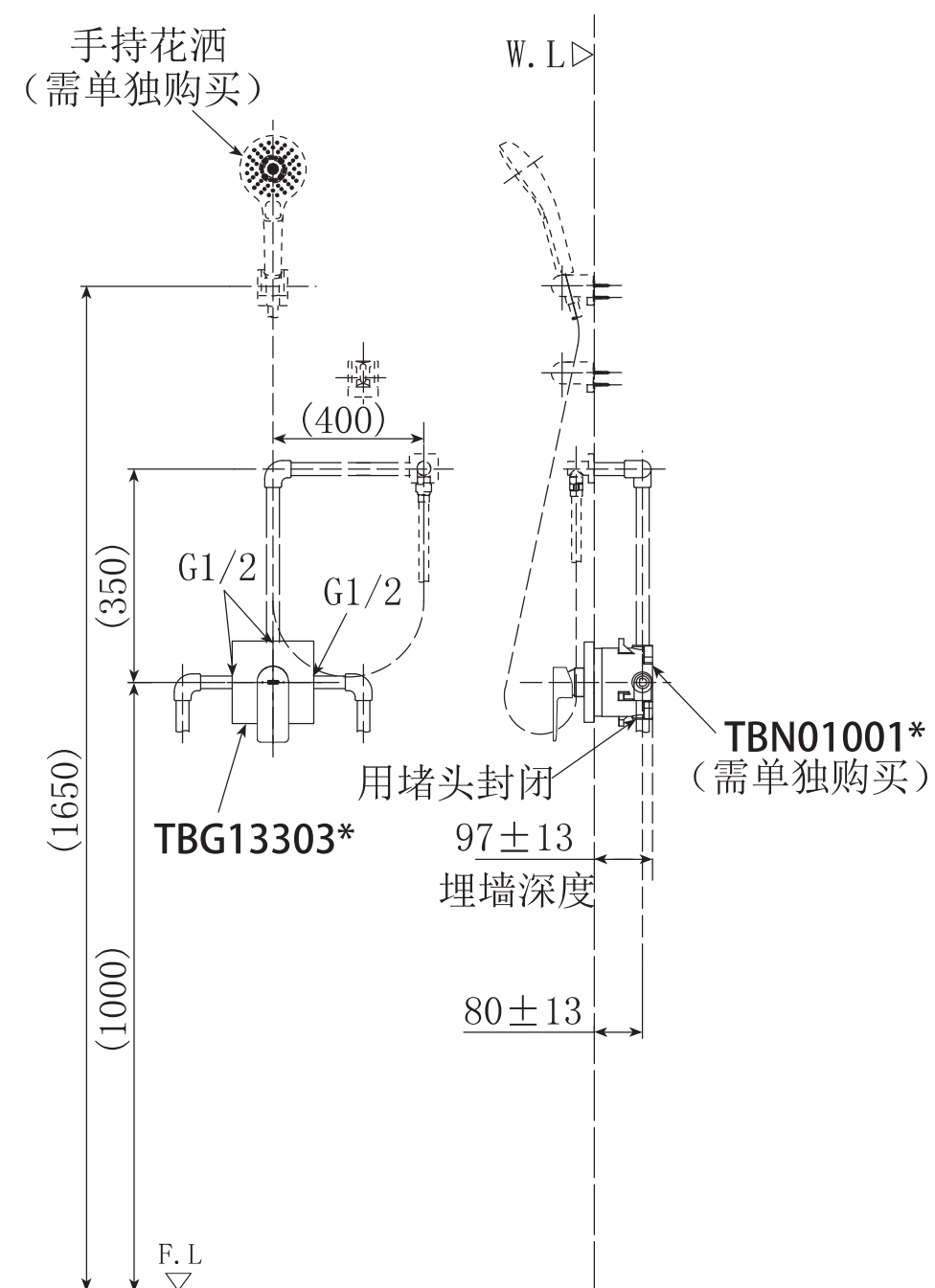

注：图中尺寸单位为mm；()内尺寸为参考尺寸。
※此产品必须与 TBN01001* 配套使用。

安装完成图

TBG13304*铜合金壁式单柄双控暗装水嘴面板（可转换）与「TOTO」的其他产品配合示意图

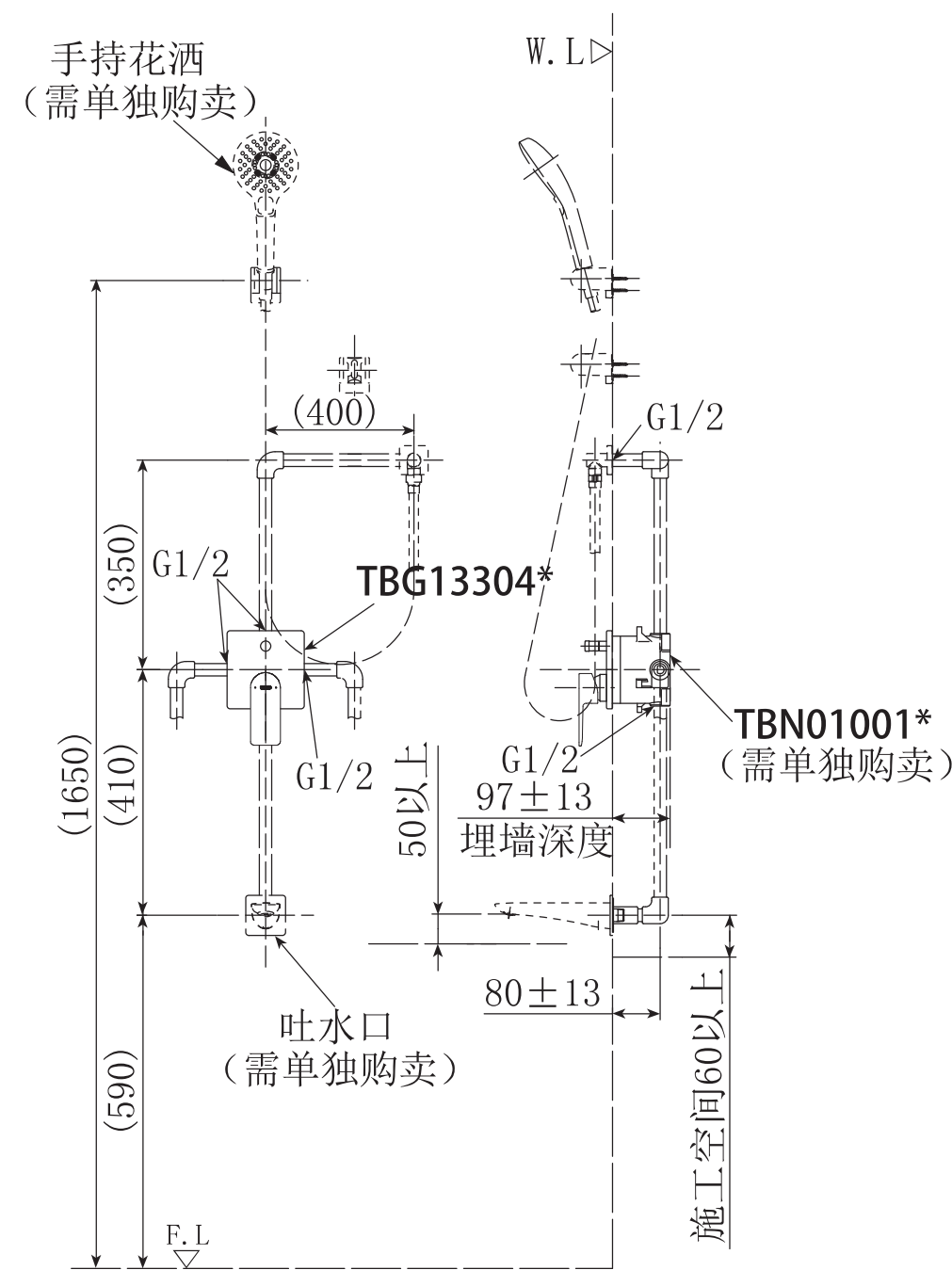

注：图中尺寸单位为mm；()内尺寸为参考尺寸。
※此产品必须与 TBN01001* 配套使用。

水嘴的安装

安装前准备的工具



安装前确认

- 确认供水管已经关闭，确认安装前水路进行清洗了。
- 仔细阅读施工说明书并按照说明书的安装要领来进行安装。

一、水嘴安装前的准备

1. 首先进行冷热水供水管路的清洗及耐压检查。
2. 使用刀锯将埋入盒装本体凸出墙面的部分进行切除，需要保证树脂套凸起边缘与墙面在2mm以内。（边缘也不能凹陷于墙面以内）。

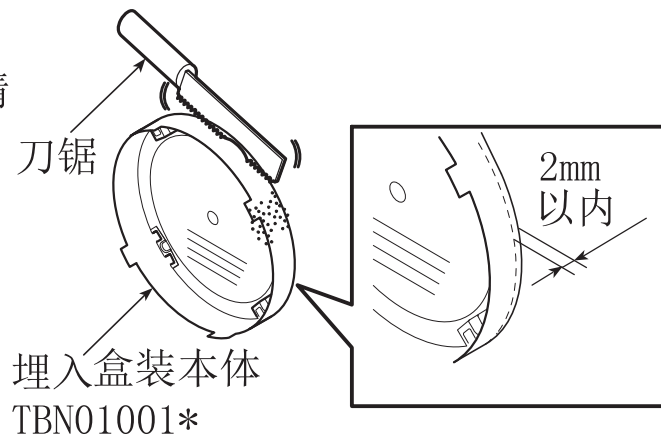

注意

- 埋入盒装本体外壳切割时要注意切边整齐。
- 保护盖切割时可能被划伤，不影响整个产品的使用。

3. 在埋入盒装本体与墙面的缝隙中均匀涂上防水胶，且胶面不能凸出墙面。
4. 取下保护盖，再用六角扳手拆下冲洗盖。

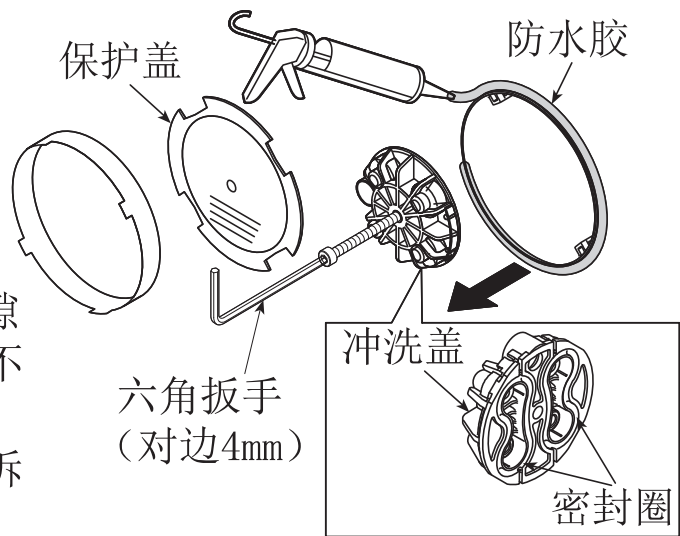

水嘴的安装

二.水嘴主体部的安装

1. 取出水嘴主体部，取下保护盖。
2. 水嘴主体的切替部向上方向装入埋入盒装本体内，并用螺钉充分紧固。（主体上的“UP”向上方向安装）

注意

- 取下保护盖时注意螺钉不要掉落丢失，O型圈不能脱落。
- 水嘴主体的螺钉请用产品包装内的六角扳手紧固。
- 水嘴主体的安装方向不能上下颠倒。

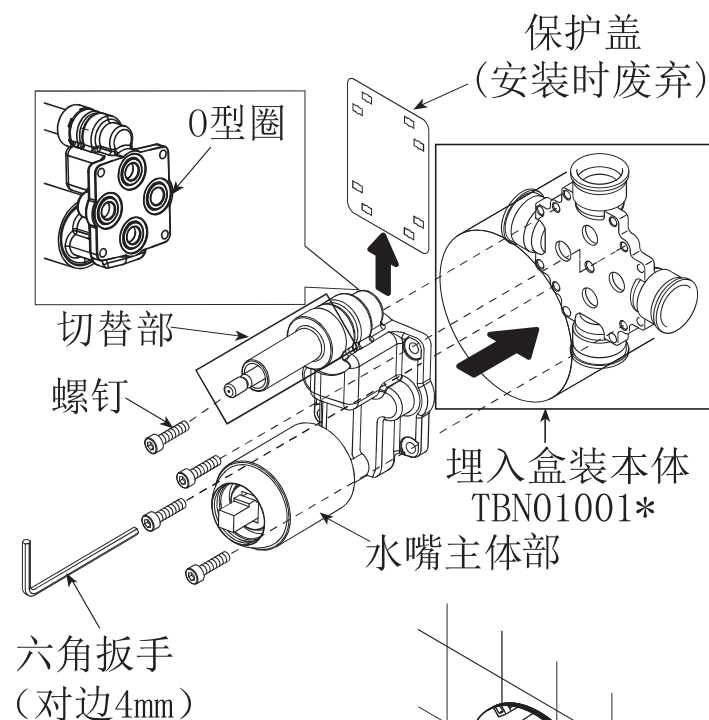

三.衬板及装饰板的安装

1. 按照衬板上“UP”指示向上状态将衬板套入水嘴主体上。
2. 用螺钉将衬板固定在埋入盒装本体内。

注意

- 安装衬板前要做耐压检查，并确认冷热水止水栓是否安全打开。
- 衬板下方有排水口，因此衬板方向不能上下颠倒安装。
- 衬板上有发泡密封胶条及下方有排水口，因此衬板边缘不要使用防水胶。
- 螺钉需要手动拧紧，不可用电动工具猛力拧紧。
- 螺钉紧固时必须压实衬板，衬板与墙面没有缝隙。

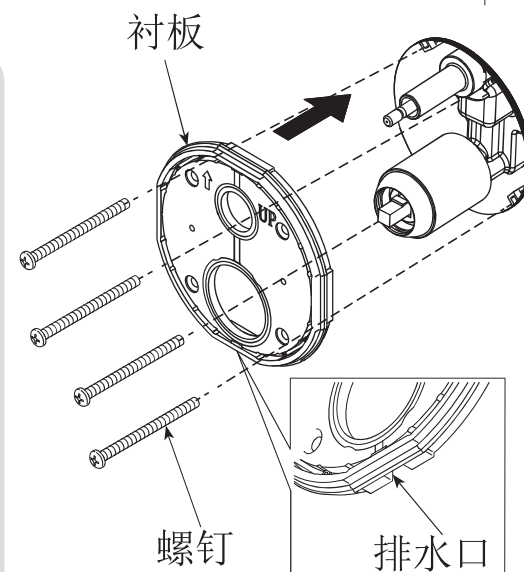

水嘴的安装

3. 将装饰板的排水口朝下，穿过阀芯套安装在衬板上。
4. 装饰板与墙面之间的缝隙保持在1mm以内。

注意

- 安装装饰板时注意不要划伤阀芯套
- 装饰板的边缘不可涂防水胶，因为装饰板下方有排水口

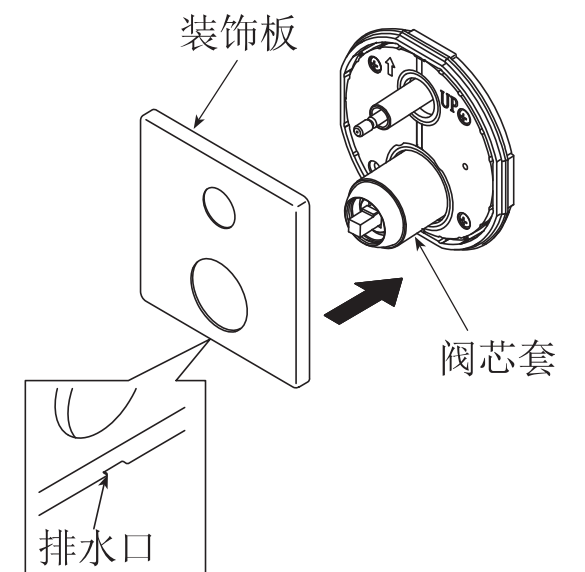
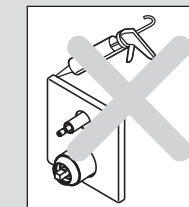

四.手柄部及切替捏手部的安装

1. 将切替捏手安装到切替拉杆上，并用螺钉将其固定在切替拉杆上。
2. 将手柄安装到阀芯上，并用螺钉将其固定，最后将表示盖安装在螺钉孔位置。

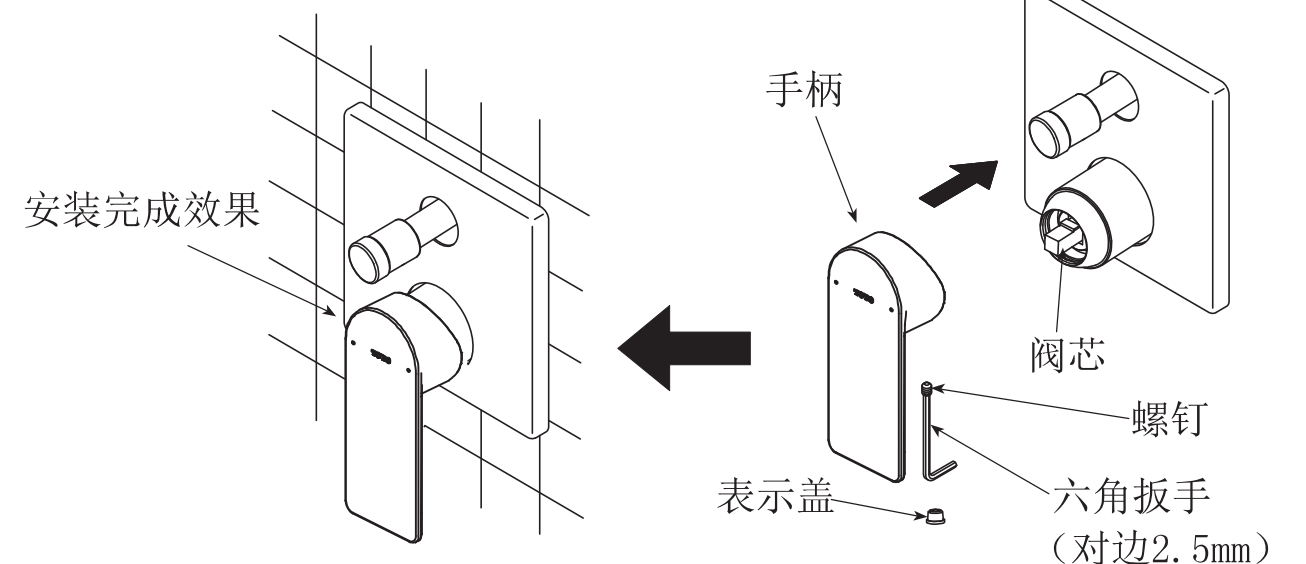
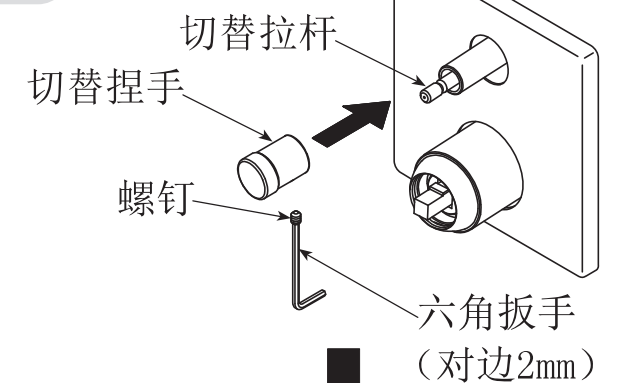

生产厂家与销售商

产品型号：见包装箱上的标签
产品名称：见包装箱上的标签
生产日期：见包装箱上的标签
组装工厂：东陶机器(广州)有限公司

厂 址：广州市番禺区南村镇兴南大道715号

东陶(中国)有限公司
全国售后服务电话：800-820-9787(固定电话)
400-820-9787(手机用户)



扫描二维码，
服务预约，方便快捷

销售商：东陶(中国)有限公司
地 址：北京市朝阳区光华路1号 北京嘉里中心北楼1915室
网 址：www.toto.com.cn

Table of Contents

Table of Contents

Table of Contents 1

Specification 2-3

Use Conditions and Attention
on Installation..... 4

Attention and maintenance
for Installation 5

Installation completion diagram..... 6-7

Installation of Spout 8-10

Specification

Specification

Main Body of the Spout	1 set
Handle	1 set
Diverter knob	1 set
Decorative plate	1 piece
Lining plate	1 piece
Screw	4 pieces
Hex wrench	1 piece
Installation Manual	1 copy
User Manual	1 copy

Specification

Products using this specification include

TBG13303* "GT" Concealed Mixing Valve

TBG13304* "GT" Concealed Mixing Valve with Diverter



Note: TBG13303* has no diverter knob.

Use Conditions and Attention on Installation

Use Conditions

- 1. Pressure for cold water * hot water supplying
 - Minimum pressure...0.05 MPa (flow pressure)
 - Maximum pressure...1.0 MPa (static pressure)
 - Recommended pressure...0.1 ~ 0.5 MPa (flow pressure)
 - Detection pressure...1.6 MPa (static pressure)
- 2.The water supply temperature is between 4℃ and 90℃. It is recommended to use hot water temperature of 60℃. Do not use steam when supplying hot water.
- 3.Ambient temperature of the use above 0℃. If it is lower than 0℃, the spout will have some issues such as deformations, cracking, etc.
- 4.When it is not used for a long time, it may cause the inside and outside of the spout to rust and corrode, leading to malfunction.
- 5.If you need to dispose of this product, do not dispose of it as general household waste. Please follow the regulations to properly dispose, recover and recycle it through an independent recycling system.
- 6.The products stated in the Manual have a cleaning function.

Attention on Installtion

-  Warning : Indicates that if you overlook this sign, causing misoperation, it may result in serious injury or death.
-  Attention : Indicates that if you overlook this sign, causing misoperation, it may cause personal injury or property damage.

Warning

- 1.As one side of the spout to supply hot water is in a high-temperature state, do not let the skin be directly in contact with the surface of the hardware fitting; otherwise it may cause burn injuries.
- 2.Do not assemble cold * hot water tubing incorrectly; otherwise it may cause burn injuries.
- 3.Do not use steam when supplying hot water; otherwise it may cause burn injuries.
- 4.When you switch from the water outlet side to the shower side, or from the shower side to the water outlet side directly, the water temperature will change, so please use the water after feeling the water temperature with the hand, otherwise scalding may occur.

Attention and Maintenance for Installation

Attention

- 1. Since the ceramic valve spool is a relatively precise component, do not disassemble it without authorization; otherwise it may cause water leakage and other defects.
- 2. Do not hit this product; otherwise it may cause malfunction or water leakage.
- 3. As the product model is constantly updated, the actual product may not look the same as it is shown in the diagram, but the basic installation and operation principles are the same.
- 4. Due to water supply inspection before this product leaves the factory, there may be residual water in the faucet, and this is not a product problem.
- 5. When using in places where icing may occur, anti-freezing measures must be taken.The parts will be damaged due to icing, which may cause water leakage and property loss. Damages caused by icing are repaired for a fee even during the warranty period. Please ensure that the ambient temperature of the product is always above 0℃.

Anti-freezing measures

- When using in places where icing may occur, anti-freezing measures must be taken.
- 1. The parts will be damaged due to icing, which may cause water leakage.
 - 2. Damaged parts caused by icing are repaired for a fee even during the warranty period.
 - 3. After the construction is completed or when it is not used for a long time, prepare to prevent sudden drop of temperature and prevent the product from icing.
 - 4. Because of the risk of icing, please ensure that the ambient temperature of the product is always above 0℃.

Maintenance

- In order to maintain the decent appearance of the product for a long time, please maintain it according to the following methods.
- 1. Wipe with a soft cloth often, or wipe with a soft cloth with water occasionally.
 - 2. When there is dirt and it is obvious, please wash it with water thoroughly after wiping it with neutral detergent.

Installation completion diagram

TBG13303*Concealed Mixing Valve

Diagram of [this product] fitting with other [TOTO] products

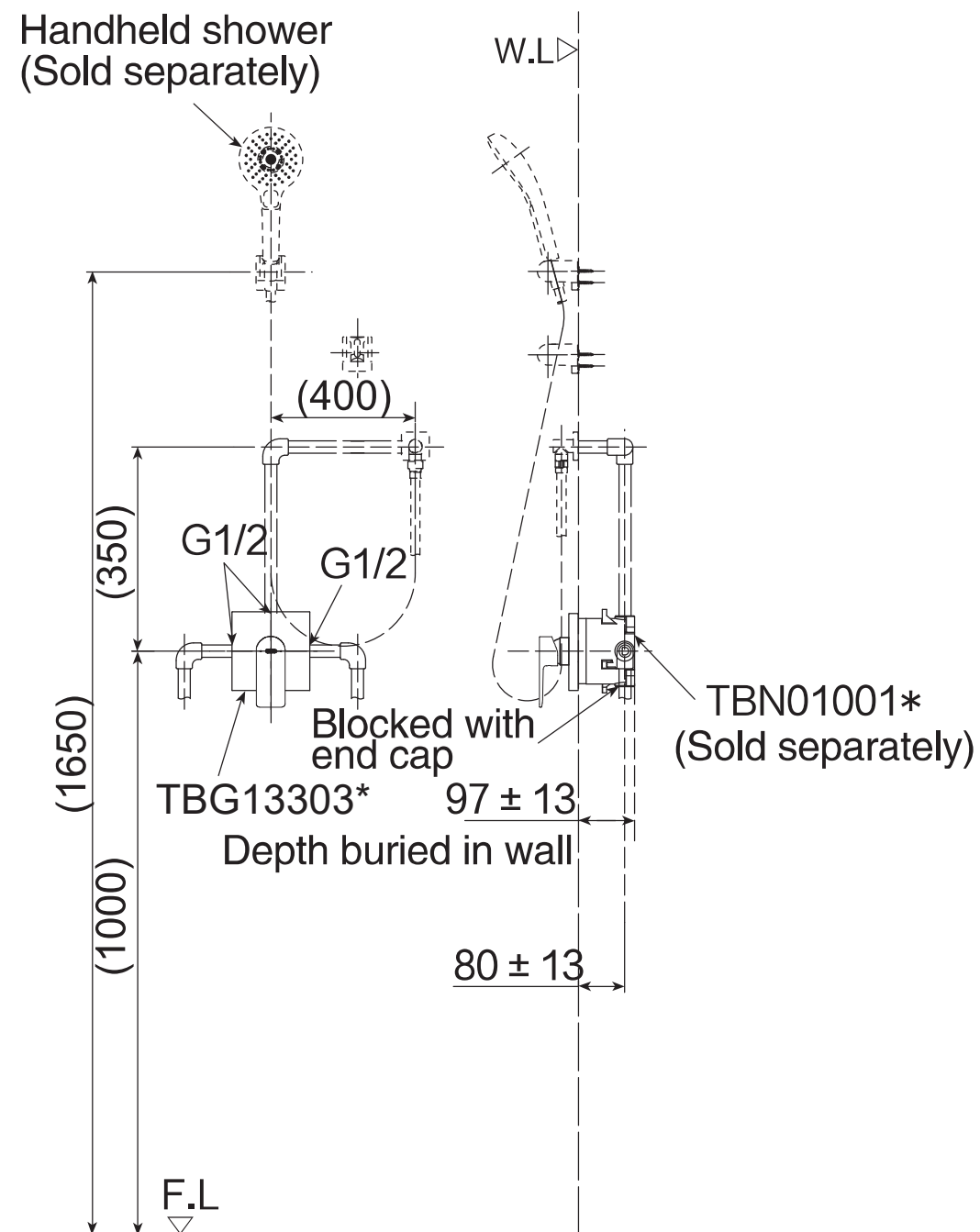

Note: The unit of size in the figure is mm

The size in the () is the reference size

※ This product must be used with TBN01001*.

Installation completion diagram

TBG02304*Concealed Mixing Valve with Diverter

Diagram of [this product] fitting with other [TOTO] products

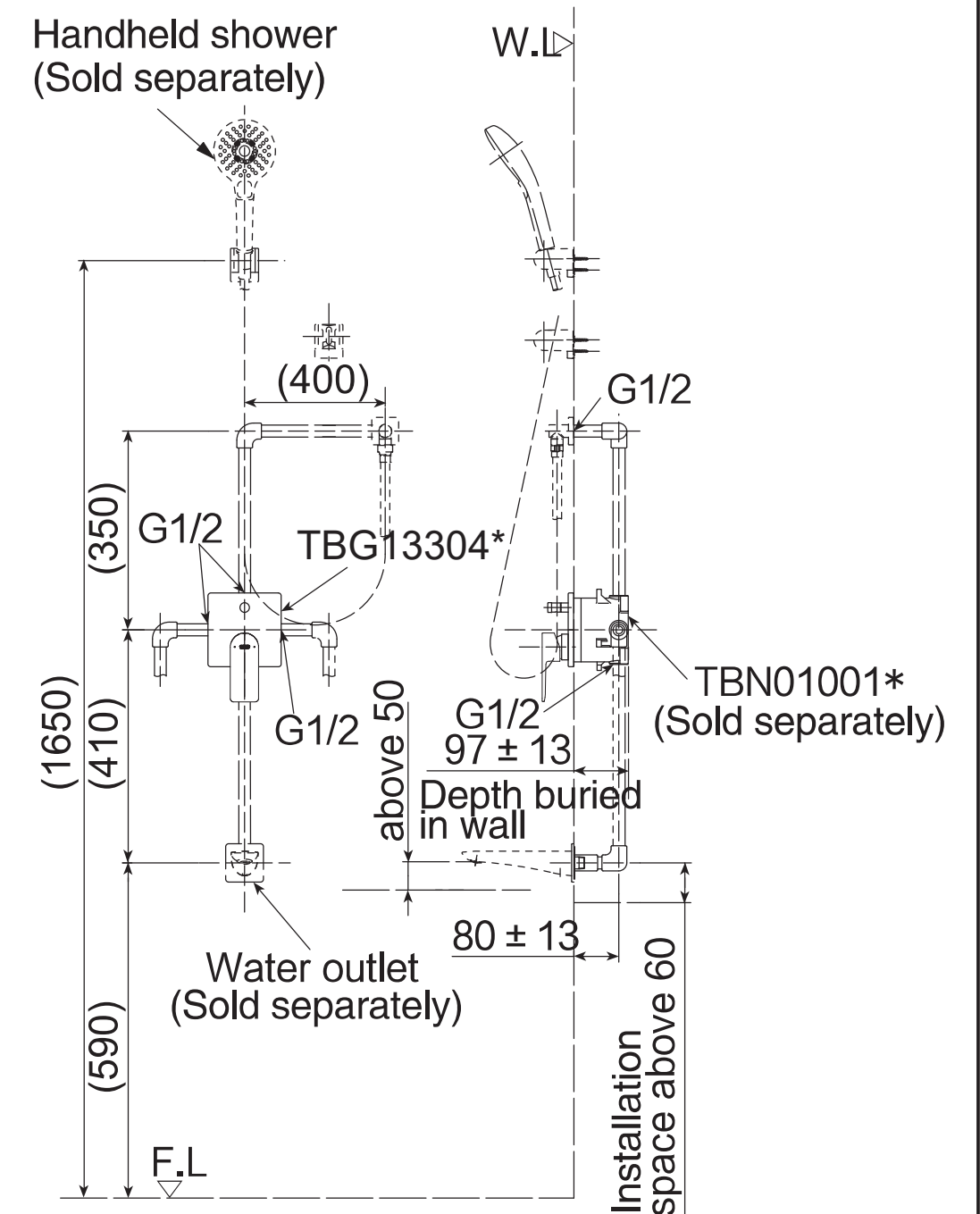

Note: The unit of size in the figure is mm

The size in the () is the reference size

※ This product must be used with TBN01001*.

Installation of Spout

Tools prepared before installation

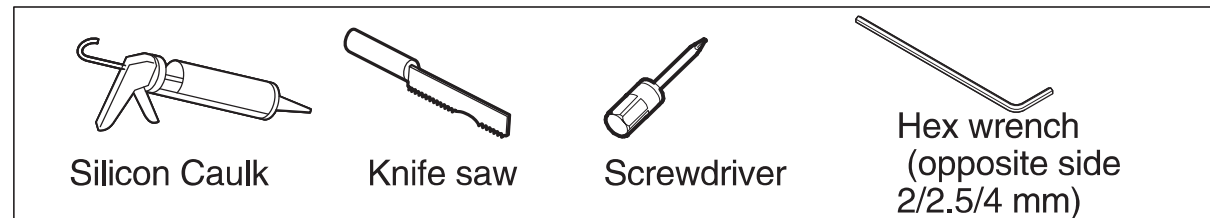

Confirmation before installation

- Confirm that the water supply pipes have been turned off and the water route has been washed before installation.
- Please read the Installation Manual carefully and install the product following the main points for installation in the manual.

I.Preparation before installation of faucet

1. Wash the cold/hot water supply pipelines and inspect pressure resistance firstly.
2. Use the saw to cut the part of Mini Unit main body protruding from wall, and ensure the protruding edge of resin is within 2mm from the wall surface. (Do not let the edge sink in the wall, either.)

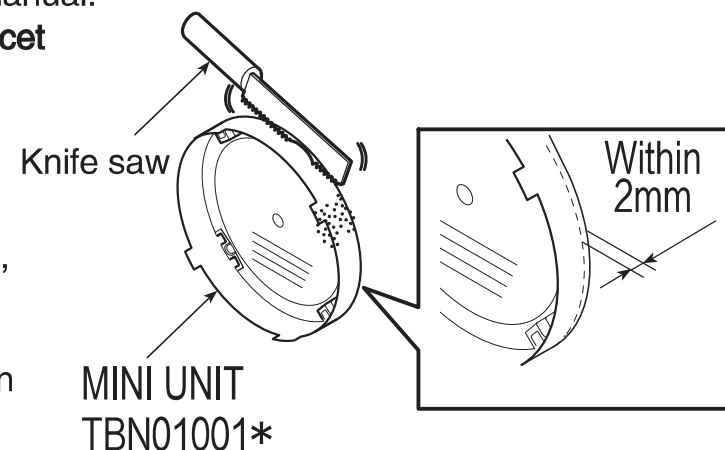

Attention

- Pay attention to that the edge should be cut orderly when cutting the Mini Unit main body shell.
- The protective cover may be scratched at cutting, but this does not affect the use of product.

3. The silicon caulk is applied evenly in the space between the Mini Unit main body and the wall surface, and the glued surface should not protrude from the wall surface.
4. Take down the protective cover, and remove the washing cover with hex wrench.

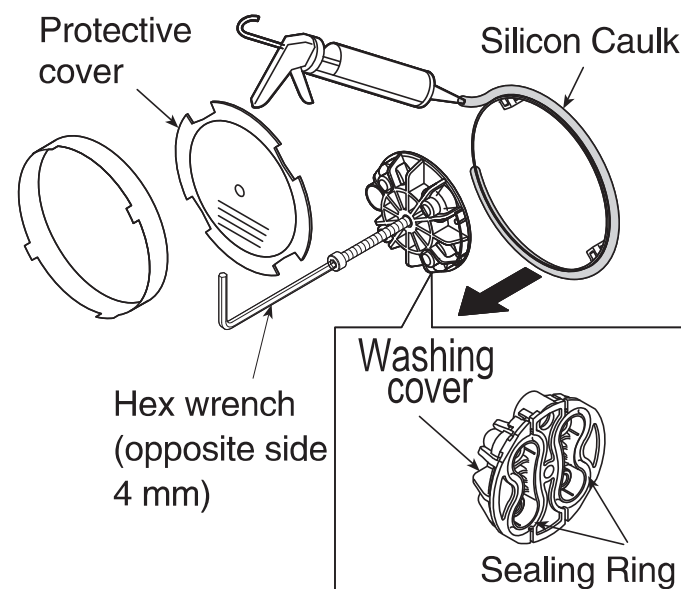

Installation of Spout

II.Installation of main faucet body

1. Take out the main faucet body part, and then remove the protective cover.
2. Enclose the diverting part of the main faucet body into the Mini Unit main body in an upward direction, and fasten it sufficiently with screws. the "UP" part on the main body is installed in a upward direction)

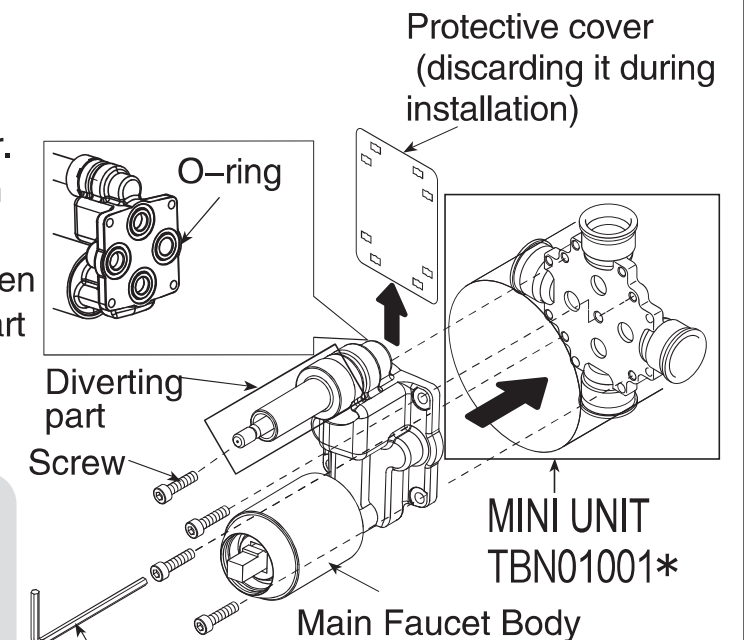

Attention

- Take care not to lose any screw and ensure O-ring does not come off when removing the protective cover.
- Please fasten the screws of main faucet body with the hex wrench in the product package.
- Please do not install the main faucet body in a upside-down direction.

Hex wrench (opposite side 4 mm)

Effect after completion of installation

III.Installation of lining and decorative plates

1. Put the lining plate sleeve on the main faucet body in a direction of "UP" indicated on the lining plate.
2. Fasten the lining plate on the Mini Unit main body with screws.

Attention

- Perform a pressure resistance inspection before installation of lining plate, and confirm whether the cold/hot water stopcock is turned on safely.
- The water outlet is located below the lining plate, as the lining plate cannot be installed in an upside-down direction.
- There is a foaming sealing rubber strip on the lining plate and a water outlet below it, so the silicon caulk should not be used on the edge of the lining plate.
- The screws need to be tightened manually, and should not be tightened with a strong force using an electric tool.
- The lining plate must be compacted when the screws are tightened, and there should be no gap between the lining plate and the wall surface.

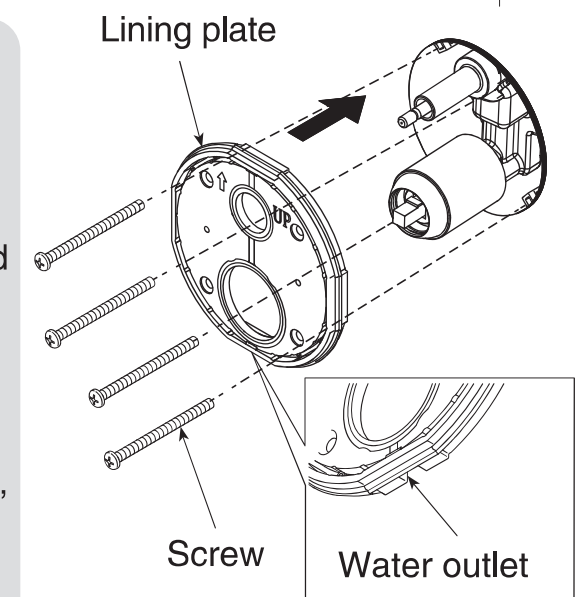

Installation of Spout

3. Make the water outlet of decorative plate face down, pass through the cartridge sleeve and install on the lining plate.
4. Keep the space between the decorative plate and the wall surface within 1 mm.

Attention

- Take care not to scratch the cartridge sleeve when installing the decorative plate.
- Do not apply the silicon caulk on the edge of the decorative plate, as there is a water outlet below the decorative plate.

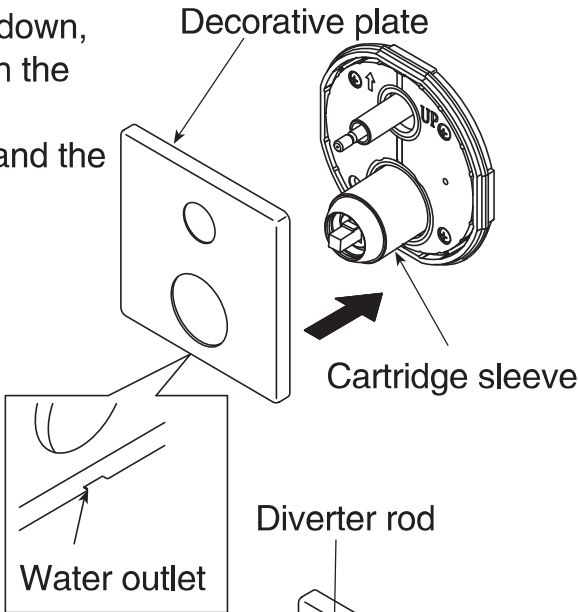
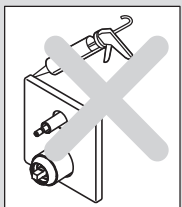

IV. Installation of handle and diverter knob

1. Install the diverter knob on the diverter rod, and fix it on the diverter rod with screws.
2. Install the handle on the cartridge, fix it with screws and finally install the indicating cover on the location of screw hole.

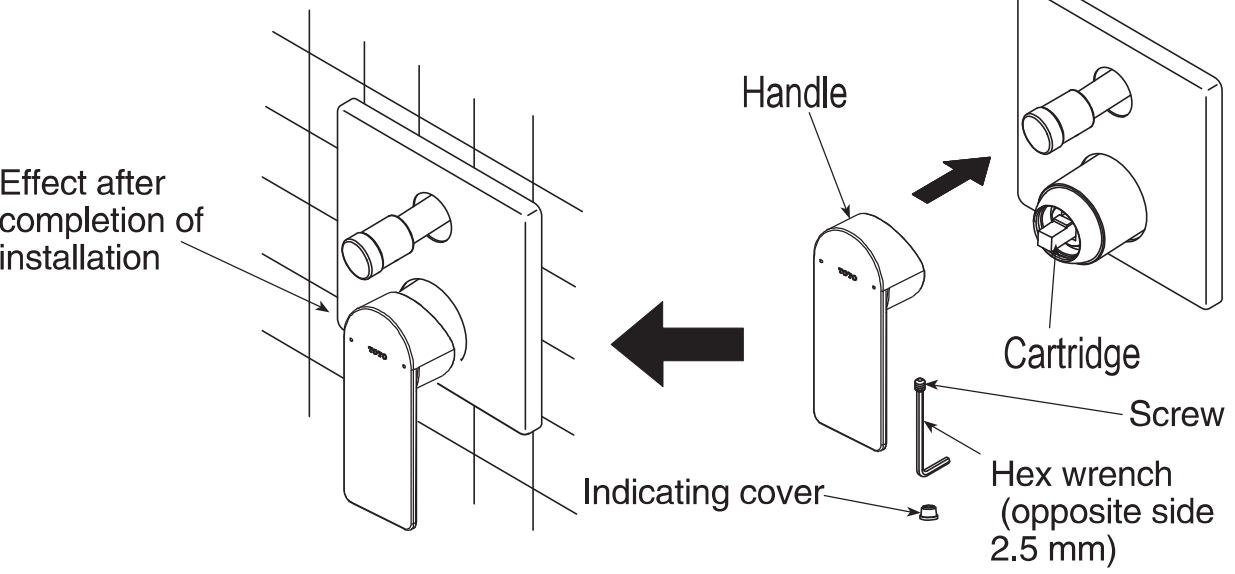
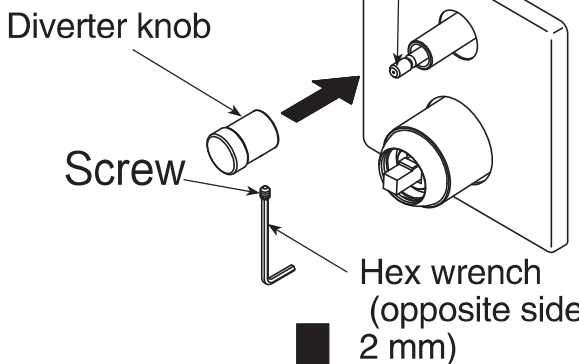

TOTO

TOTO ASIA OCEANIA PTE. LTD.	10, Eunos Road 8, #12-07, Singapore Post Centre. Singapore 408600. Phone: +65-6744-6955 Fax: +65-6841-0819 http://asia.toto.com/
TOTO ASIA OCEANIA PTE. LTD. Manila Representative Office.	Unit 706, Rufino Building, Ayala Avenue Corner V.A. Rufino Street, Makati City, 1226, Philippines Phone: +63-2-8887-6643 Fax: +63-2-887-4084 http://asia.toto.com/
TOTO ASIA OCEANIA PTE. LTD. Yangon Branch	# 0608 Sakura Tower, 339 Bogyoke Aung San Rd, Kyauktada Township, Yangon, Myanmar http://asia.toto.com/
TOTO ASIA OCEANIA PTE. LTD. Middle East Branch	LOB19-1701-1702, Jebel Ali Free Zone, P.O. box 261804, Dubai U.A.E. Phone: +971-4-886-5983 Fax: +971-4-886-5986 http://asia.toto.com/
TOTO INDIA INDUSTRIES PVT. LTD	1002, Kamla Executive Park, Opposite Vazir Glass Works, Andheri Kurla Road, Andheri (E), Mumbai—400059. Maharashtra, India. Phone: +91-22-43112-111/112 Fax: +91-22-28325741/42 https://in.toto.com/
TOTO (H.K.) LIMITED	Room 1101, 11/F., No.3, Lockhart Road, Wanchai, Hong Kong. Phone: (852)2861 3177 Fax: (852)2861 3563 http://hk.toto.com/
TOTO KOREA LTD.	9F, Gongdeok Bldg, 11 Saechang-ro, Mapo-gu, Seoul, Republic of Korea Phone: +82-2-3141-8236 FAX: +82-2-3141-8240 https://kr.toto.com/

• You are advised to record the following information to allow quick service.

Date of purchase:	Name of shop:
Date:year month day	Tel:()